

**INBOARD**

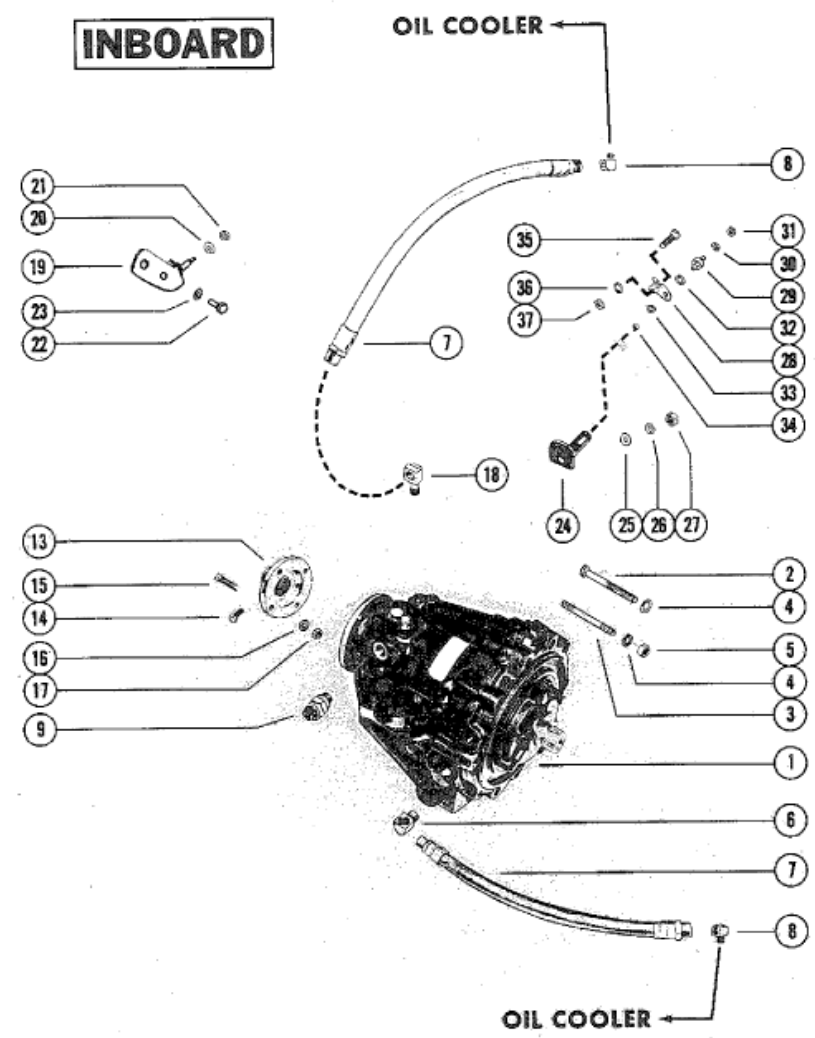

Parts List						
Ref	Class	Part	Description	Qty	Comment	Footnote
1		47805	TRANSMISSION (DIRECT DRIVE)	1,...		
1		47806	TRANSMISSION (1.52:1 REDUCT	,1,...		
1		47807	TRANSMISSION (1.909:1 REDUCTI	,,1,...		
1		47808	TRANSMISSION (2.57:1 REDUCT	,,,1,		
1		47809	TRANSMISSION (2.909:1 REDUC	,,,,1		
2	10	47724	SCREW, TRANSMISSION TO ENI	4,...		
2	10	60179	SCREW, TRANSMISSION TO ENI	,6,6,6,E		
3	16	57921	STUD, TRANSMISSION TO ENGI	2,...		
4	13	32993	LOCKWASHER, TRANSMISSION	6,6,6,6,		
5	11	22024	NUT, TRANSMISSION STUD	2,...		
6	22	47629	ELBOW, HOSE TO TRANSMISSIC	,1,1,1,1		
6	22	63835	ELBOW, HOSE TO TRANSMISSIC	,1,1,1,1		
7	32	47516 10	HOSE, TRANSMISSION TO OIL C	1,1,1,1,		
7	32	47516 6	HOSE, TRANSMISSION TO OIL C	1,1,1,1,		
8	22	47629	ELBOW, HOSE TO OIL COOLER	2,...		
9		47613	SWITCH, NEUTRAL SAFETY	1,1,1,1,		
13		87917A 1	FLANGE ASSEMBLY (1")	OPT,...	SEE NOTE A	
13		87917A 2	FLANGE ASSEMBLY (1 1/8")	OPT,...	SEE NOTE A	
13		87917A 3	FLANGE ASSEMBLY (1 1/4")	OPT,...	SEE NOTE A	
13		87917A 4	FLANGE ASSEMBLY (1 3/8")	OPT,...	SEE NOTE A	
13		87917A 5	FLANGE ASSEMBLY (1 1/2")	OPT,...	SEE NOTE A	
13		79476A 1	FLANGE ASSEMBLY (1")	,OPT,...	SEE NOTE B	
13		79476A 2	FLANGE ASSEMBLY (1 1/8")	,OPT,...	SEE NOTE B	
13		79476A 3	FLANGE ASSEMBLY (1 1/4")	,OPT,...	SEE NOTE B	
13		79476A 4	FLANGE ASSEMBLY (1 3/8")	,OPT,...	SEE NOTE B	
13		79476A 5	FLANGE ASSEMBLY (1 1/2")	,OPT,...	SEE NOTE B	
14	10	60168	SCREW, FLANGE TO PROPELL	2,...	SEE NOTE A AND B	
14	10	60170	SCREW, FLANGE TO PROPELL	2,2,2,2	SEE NOTE A AND B	
14	10	60169	SCREW, FLANGE TO PROPELL	2,...	SEE NOTE A AND B	
15	10	52498	SCREW, FLANGE TO PROPELL	4,4,4,4,		
16	13	32993	LOCKWASHER, FLANGE SCRE	4,4,4,4,		
17	11	22024	NUT, FLANGE SCREW	4,4,4,4,		
18	22	47629	ELBOW, HOSE TO TRANSMISSIC	2,2,2,2,		
19		63815A 1	BRACKET, SHIFT CABLE	1,1,1,1,		
20	12	56681	WASHER, SHIFT CABLE TO BRAI	1,1,1,1,		
21	11	46438	NUT, CABLE TO BRACKET STUD	1,1,1,1,		
22	10	35585	SCREW, BRACKET TO TRANSMI	2,2,2,2,		
23	13	26992	LOCKWASHER, BRACKET SCRE	2,2,2,2,		
24		48515	LEVER, SHIFT - TRANSMISSIO	1,1,1,1,		
25	12	20722	WASHER, SHIFT LEVER TO TRA	1,1,1,1,		
26	12	26992	LOCKWASHER, SHIFT LEVER TO	1,1,1,1,		